

**BUTLER
COUNTY,
OHIO**

Meeting **PLANNER GUIDE**

**YOUR SUCCESS
IS THE ULTIMATE PLAN!**

TABLE OF CONTENTS

Welcome to Butler County, Ohio	1
Top Five Reasons to Meet in Butler County	2
Getting Here is Easy	3
Need Help? We Are Here For You	4
Full Service Meeting Facilities	5
Select & Limited Service Hotels with Space	13
Unique & Flexible Meeting Space	15
Venue Space Under 10,000 Sq. Ft.	15
Venue Space Over 10,000 Sq. Ft.	17
Where to Have Fun	19
Contact Us	22

Welcome to BUTLER COUNTY, OHIO

YOUR SUCCESS IS THE ULTIMATE PLAN.

At the Butler County Visitor's Bureau, we're here to make things easier. Our professional staff can help you craft an exceptional experience for your attendees. We're here to assist you in pulling all the details together—before, during and after your event—with an unmatched level of service and support.

We've created this guide to share all about Butler County, and to highlight how we specialize in helping meeting planners organize successful meetings and events.



Top Five

REASONS TO MEET IN BUTLER COUNTY



1

Location, location, location. Butler County is located conveniently between Cincinnati (20 minutes) and Dayton (30 minutes) and easily accessible from I-75 and I-275. Butler County is within a one-day drive of 65% of the US population.



2

Our Service is Second to None. From day one, the Butler County Visitors Bureau staff takes care of you and your event. We provide custom services and a level of support that is top in the travel industry. Every event, large or small is important to us.



3

Flexible & Unique Meeting Space & Accommodation Options. With top-notch meeting space, unique off-site options and a variety of contemporary and new hotels, Butler County is fully customizable to your event's needs.



4

Attractions & Activities Found No Where Else. Where else can you find the world's largest indoor train display, a cable wake park, a Donut Trail and an international market featured on The Travel Channel? We're one-of-a-kind!



5

Exceptional Dining. From historic cities to a trendy college town to new hot spots, Butler County's communities offer an eclectic mix of experiences all in one location. Your perfect meeting is waiting to be discovered.

GETTING TO BUTLER COUNTY IS *Easy*



In so many ways, Butler County is the perfect place for your next conference, meeting or event. For starters, Butler County is in an easily accessible location just north of Cincinnati and south of Dayton. In fact, getting to **Butler County is only a one-day drive for more than 60% of the entire U.S. population.** Traveling to Butler County couldn't be easier due to the major roads and highways that service our region. Interstate Highways include 27, 42, 70, 71, 75 and 275. State Highways include 4, 63, 126, 129, and 747. And two major airports serve Butler County—each one is just 35 miles away.

TWO INTERNATIONAL AIRPORTS SERVICE BUTLER COUNTY:



Cincinnati Northern Kentucky Int. Airport (CVG)

939 Terminal Dr., Hebron, KY 41048

www.cvgairport.com



INTERNATIONAL AIRPORT
Easy to and through.

Dayton International Airport (DAY)

3600 Terminal Drive, Dayton, Ohio 45377

www.daytonairport.com

When you come to Butler County for the first time, you'll find much more than you expected. Butler County features an eclectic mix of historic cities, suburban developments, rural farmlands, lush scenery, and even an energetic college town. Butler County isn't just one place; it's many distinct communities. Each one offers a flavor that's all its own. You will find a variety of attractions, comfortable accommodations, shopping spots and hidden historical gems.

Need Help?

WE ARE HERE FOR YOU



Service

At the Butler County Visitors Bureau, we are dedicated to helping you organize a successful convention, conference, meeting or event. Our unmatched service includes on-site assistance to make sure your event goes smoothly. For example, we can help you by staffing "Information Stations" or providing "Welcome Packets" to attendees.

Site Visits

To help you plan your event, come enjoy a customized FAM tour, including site inspections of hotels, venues, and attractions.

RFP & Itinerary Development

If you need a proposal generated, simply call us and we will send out your request for proposals to all locations that suit your needs, and customize an itinerary just for your group. The proposal can include rates, off-site activities, group transportation, unique teambuilding events, and more.

Promotional Items

Complimentary promotional items are available, such as customized emails or maps and visitor guides for promotional use during your event.





Where to MEET & STAY

PRODUCTIVE SPACES AND RELAXING PLACES.

Butler County is a great place for your next meeting or event. Our communities offer a variety of hotel choices and meeting facilities that are flexible and ready to make your next meeting or event a success. From full service properties to modern select service options to a variety of unique venue spaces, Butler County offers great options for all kinds of meeting planners and groups.

FULL SERVICE MEETING FACILITIES

Venue	Number of Rooms	Meeting Space Cap.	Total Sq. Ft.	Theater Capacity	Reception Capacity	Classroom Capacity	Banquet Capacity
Centre Park of West Chester - Holiday Inn	130	1480	20327	1480	650	630	750
Cincinnati Marriott North	295	400	14000	770	960	480	500
Courtyard by Marriott Hamilton	120	300	6500	560	500	388	340
Four Points by Sheraton	90	284	4622	284	500	240	284
Hilton Garden Inn West Chester	125	210	3500	380	320	220	260
The Marcum Hotel and Conference Center at Miami University	55	150	16927	275	250	120	160

**Centre Park of West Chester
Holiday Inn**



**5800 Mulhauser Rd
West Chester, OH 45069
www.middletownhotelmanagement.com
(513) 874-2744**

A modern, contemporary, state-of-the-art event & banquet center with hotel is new to West Chester in 2015. Located right off of I-75, only minutes from downtown Cincinnati and across from IKEA, this beautifully appointed property can accommodate events up to 650 people. Centre Park also features Johnny's Italian Steakhouse, an upscale restaurant featuring traditional and innovative items. The location of Centre Park is ideal for corporate events, weddings and meetings.

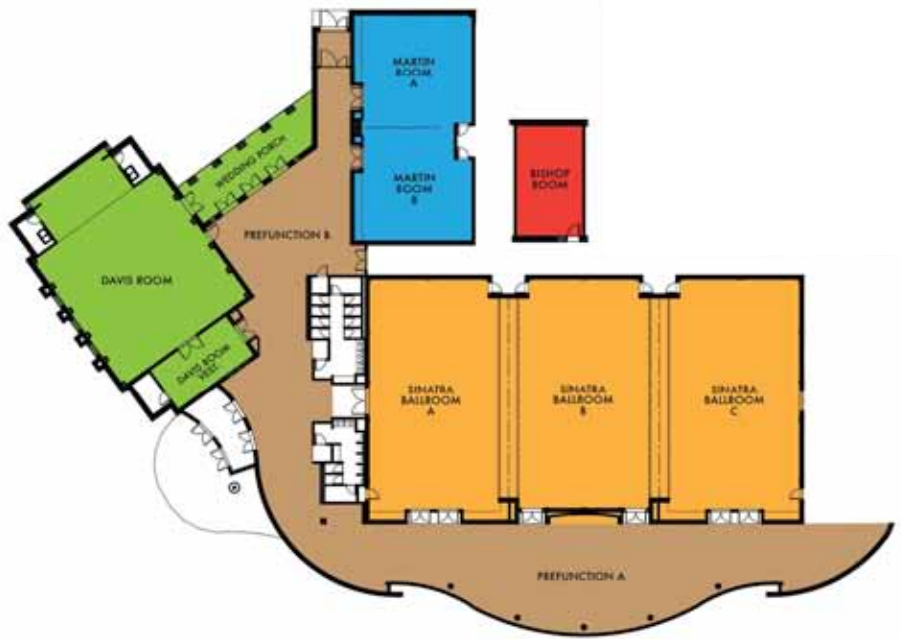

Floor Plans & Capacity Chart

Meeting Room	Dimensions L x W x H	Area Sq. Feet	Capacity by Floor Set-Up					
			Theater	Classroom	Banquet	U-Shape	Reception	Boardroom
Sinatra Ballroom	72 x 129 x 15	8909	1480	630	750	250	650	290
Sinatra Ballroom A	72 x 42 x 15	2943	490	210	250	80	210	90
Sinatra Ballroom B	68 x 42 x 15	3023	500	210	250	80	230	100
Sinatra Ballroom C	72 x 42 x 15	2943	490	210	250	80	210	90
Pre-Function A	-	3785	-	-	340	-	420	-
Martin Room	66 x 35 x 11	2265	370	160	200	60	200	70
Martin Room A	33 x 35 x 11	1154	190	80	100	30	100	30
Martin Room B	33 x 35 x 11	1111	180	70	100	30	100	30
Bishop Room	27 x 16 x 11	433	70	30	30	20	30	10
Davis Room	61 x 46 x 18	2642	440	180	200	70	240	80
Davis Room Vestibule	15 x 28 x 12	483	80	30	25	10	25	10
Wedding Porch	47 x 14 x 12	605	100	40	50	10	50	20
Pre-Function B	-	1250	-	-	110	-	130	-

Cincinnati Marriott North



MARRIOTT

6189 Muhlhauser Road
West Chester, OH 45069
www.cincinnati.marriottnorth.com
(513) 874-7335

The award-winning Cincinnati Marriott North is a luxury hotel that's perfect for the business traveler. Halfway between Cincinnati and Dayton, this hotel is located in the Union Centre area and near GE, Procter & Gamble, and AK Steel's corporate offices. Business travelers appreciate the design of the beautifully appointed guestrooms and suites with wireless high-speed internet access and executive work areas. A 24-hour Business Center is also available in the lobby. Other luxury amenities include a concierge level, fitness center, and classic American cuisine served with flair in the RiverCity Grille. With the picturesque atrium reception area, 14,000 square feet of event space, and custom catering, your event will be unforgettable at the Marriott!

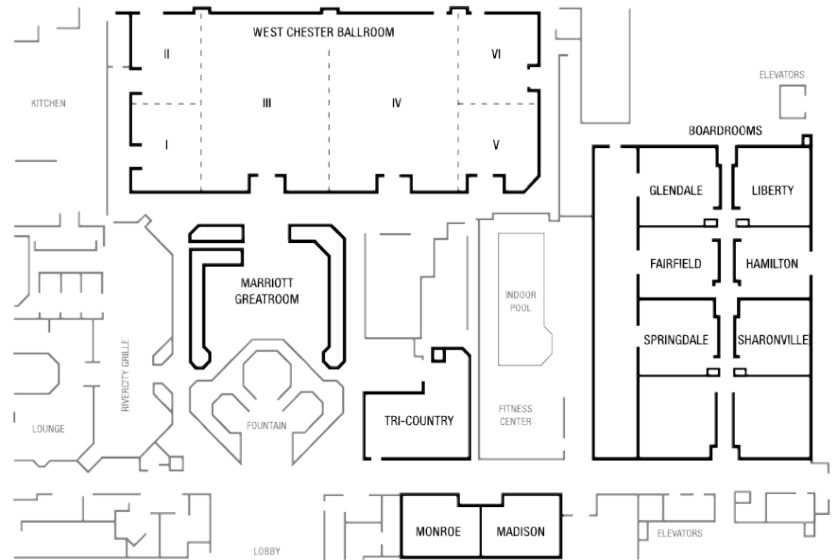

Floor Plans & Capacity Chart								
Meeting Room	Dimensions	Area	Capacity by Floor Set-Up			Room Set-Up Examples		
			Theater	Schoolroom	Conference	U-Shape	Reception	Banquet
West Chester Ballroom	136 x 55 x 14	7,480	770	480	-	-	960	500
West Chester IV	45 x 55 x 14	2,475	220	140	65	65	300	190
West Chester III	45 x 55 x 14	2,475	220	140	65	65	300	190
Atrium Terrace	44 x 44 x 25	2,000	-	-	-	-	300	100
Tri-County Meeting Room	35 x 24 x 10	1,049	85	55	28	28	105	66
West Chester VI	24 x 29 x 11	696	70	45	25	25	90	60
West Chester II	22 x 29 x 11	638	60	40	20	20	70	40
West Chester V	24 x 26 x 11	624	65	45	20	20	80	50
Sharonville Executive Boardroom	27 x 17 x 9	578	-	-	16	-	-	-
Hamilton Executive Boardroom	27 x 17 x 9	578	-	-	16	-	-	-
Liberty Executive Boardroom	27 x 17 x 9	578	-	-	16	-	-	-
Springdale Executive Boardroom	27 x 17 x 9	578	-	-	16	-	-	-
Fairfield Executive Boardroom	27 x 17 x 9	578	-	-	16	-	-	-
Glendale Executive Boardroom	27 x 17 x 9	578	-	-	16	-	-	-
West Chester I	22 x 26 x 11	572	60	40	20	20	70	40
Madison Executive Boardroom	26 x 17 x 8	454	-	-	16	-	-	-
Monroe Executive Boardroom	26 x 17 x 8	454	-	-	16	-	-	-

**Courtyard by
Marriott Hamilton**



**1 Riverfront Plaza
Hamilton, OH 45011
marriott.com/cvgha
(513) 896-6200**



Located in the heart of Butler County, the award winning Courtyard by Marriott Hamilton is a full-service hotel ideal for business and pleasure travelers alike. Situated in downtown Hamilton along the Great Miami River, the Courtyard Hamilton features 7,000 square feet of flexible meeting space perfect for small meetings and large receptions. The unique Riverview Ballroom features three breathtaking chandeliers and an outdoor terrace with fire pit making the perfect backdrop for the night of your dreams. Guests may also enjoy one of our stylish guest rooms with Marriott's luxury bedding and FREE High Speed Internet plus the Plaza One Grille restaurant, nominated as one of the best in Butler County by the Journal-News.

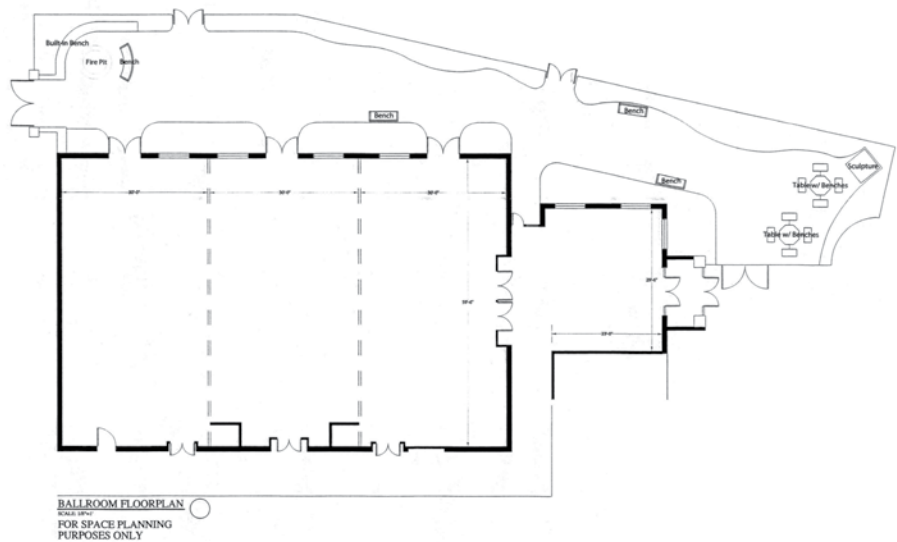

Floor Plans & Capacity Chart								
Meeting Room	Dimensions	Area	Capacity by Floor Set-Up			Room Set-Up Examples		
			Theater	Schoolroom	Conference	U-Shape	Reception	Banquet
Riverview Ballroom	60 x 89 x 12	5,340	600	350	150	75	500	340
Foundation Boardroom	28 x 16 x 10	470	-	-	14	-	-	-
Riverview A	60 x 28 x 12	1,680	110	75	50	32	150	100
Riverview B	60 x 31 x 12	1,860	110	75	50	32	150	100
Riverview C	60 x 30 x 12	1,800	110	75	50	32	150	100
Riverview AB	60 x 59 x 12	3,540	220	150	100	64	300	200
Riverview BC	60 x 61 x 12	3,660	220	150	100	64	300	200
Pre-Function	-	-	142	-	-	-	-	67

Four Points by Sheraton & Meridian Conference Center



7500 Tylers Place Blvd.
West Chester, OH 45069
www.meridianconference.com
(513) 777-1101



Perfect for both business and social events, the Meridian offers over 5,000 square feet of flexible meeting space. This facility offers a diverse menu, modern technology and an exceptional staff ready to exceed your expectations. Packed full of innovative cuisine and specialized packages for every occasion, our new menus are certain to make your next event a Tremendous Success! Ideal for Corporate Training, Corporate Celebrations, Family Gatherings and Weddings.

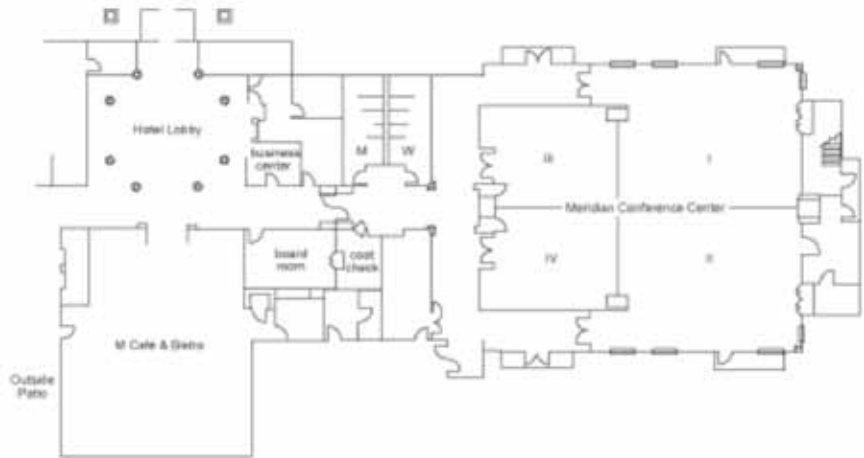

Floor Plans & Capacity Chart							
Meeting Room	Dimensions	Area	Capacity by Floor Set-Up				
			Theater	Classroom	Banquet	U-Shape	Conference
I	44 x 34 x 12	1468	95	85	95	36	48
II	44 x 34 x 12	1468	95	85	95	36	48
III	29 x 24 x 12	696	47	40	47	24	32
IV	29 x 24 x 12	696	47	40	47	24	32
I & II	68 x 44 x 12	2936	190	160	190	72	96
III & IV	48 x 29 x 12	1392	94	80	94	48	64
I, II, III & IV	72 x 68 x 12	4328	284	240	284	120	160
Board Room	21 x 14 x 10	294	-	-	-	-	12

Hilton Garden Inn West Chester



**9306 Schulze Drive
West Chester, Ohio, 45069, USA
<http://hiltongardeninn3.hilton.com>
(513) 860-3170**

Conveniently located off Interstate 75, at Exit 19, the Hilton Garden Inn West Chester hotel is less than a mile away from IKEA, and within one mile of businesses such as GE, P&G and Schneider Electric. This hotel in West Chester, Ohio, is 19 miles from downtown Cincinnati, home of the Bengals football team and the Reds baseball team. Enjoy easy access to sports venues and attractions including Kings Island – the largest amusement and waterpark in the Midwest.

Modern and inviting, guest rooms at this hotel in West Chester, Ohio offer complimentary WiFi, work area, mini-refrigerator and a Keurig® coffee maker. Upgrade to a suite for additional space and amenities. Swim in the indoor saltwater pool or energize in the complimentary 24-hour fitness center. Relax with a cocktail in the Lounge before enjoying American classics in the Garden Grille & Bar. After a busy day, unwind on the patio or read a book in the library. Plan an event for up to 210 people at this West Chester, OH, hotel with 3500 sq.ft. of function space, including a divisible ballroom, and stay productive in the complimentary 24-hour business center.



Floor Plans & Capacity Chart

Meeting Room	Dimensions L x W	Area Sq. Feet	Capacity by Floor Set-Up					
			Banquet	Theater	Conference	Classroom	Reception	U-Shape
Executive Boardroom	17' x 27'	459	-	-	12	-	-	-
West Chester A	41' x 39'	1599	72	100	30	48	150	22
West Chester B	41' x 38'	1,444	72	100	30	48	150	22
West Chester Ballroom	41' x 77'	3,042	144	200	60	96	300	44

The Marcum Hotel & Conference Center at Miami University



THE MARCUM
HOTEL & CONFERENCE CENTER
AT MIAMI UNIVERSITY

351 N Fisher Dr
Oxford, OH 45056
www.muohio.edu/marcum
(513) 529-6911



Located on the beautiful campus of Miami University is The Marcum Hotel and Conference Center—a truly unique venue. The distraction-free environment, elegant facilities, beautiful gardens and grounds, and affordable pricing have made our property a favorite location since 1982. With comfortable guest rooms, 13,000 square feet of meeting space, elegant banquet space, and a cozy tavern, it is a popular site for conferences, training, meetings, banquets and overnight stays. Individual guests and groups enjoy our quiet, wooded setting that is within walking distance of all campus facilities and the quaint uptown of Oxford, Ohio. A wide range of recreational and cultural activities are also offered on campus.



Floor Plans & Capacity Chart

Room Name	Dimensions	Area	Capacity by Floor Set-Up			Room Set-Up Examples				
			Theater	Classroom	Conference	U-Shape	Block O	Reception	Dining Rounds	Dining Rectangles
108	15 x 38	570	50	24	12	16	20	36	24	15
110	26 x 38	988	80	36	18	24	28	80	48	36
108 - 110	41 x 38	1,588	149	66	20	36	40	130	72	48
112	26 x 40	1,040	-	-	-	-	-	50	-	25
124	18 x 20	360	30	18	12	10	12	15	12	16
126	14 x 18	252	12	-	6	-	-	-	6	6
154	27 x 39	1,050	100	48	20	21	26	85	60	42
158	36 x 39	1,400	120	60	26	26	36	120	72	72
154 - 158	39 x 63	2,450	275	120	-	60	70	250	160	150
180	14 x 40	560	50	24	12	16	20	36	24	15
184	20 x 40	800	80	36	18	24	28	80	48	36
186	30 x 40	1,200	120	60	20	30	36	120	60	42
180 - 184	39 x 40	1,560	135	66	20	36	40	130	72	48
184 - 186	40 x 50	2,000	200	100	22	40	48	200	84	72
180 - 184 - 186	40 x 64	2,560	275	120	-	60	70	250	160	150
Courtyard/Gazebo	Please check with your event planner for details									



Your Place to **CONNECT!**

▶ Butler County's places and spaces are ready to help nurture and grow connections.

The power of a face-to-face meeting cannot be measured. From flexible and functional meeting space to brand new entertainment options, both work time and down time are opportunities to connect. Let us help connect your attendees and take your event to the next level!

Select & Limited Service Hotels with Meeting Space

Butler County's select and limited service properties boast great rooms and flexible meeting space. Your small to medium-sized group can hold a corporate retreat and then relax in style at one of our trusted brands. These properties are also perfect for room block overflows for larger events.

		All Non-Smoking	Continental Breakfast	Meeting Space Capacity	Number of Rooms	Pet Friendly	Pool	WiFi/High-Speed Internet
FAIRFIELD	 <p>Hampton Inn Cincinnati NorthWest - Fairfield 430 Kolb Dr., Fairfield, OH 45014 (513) 461-3105 www.cincinnati-fairfield.hamptoninn.com</p>	Yes	Yes	25	100	No	Indoor	Yes
	 <p>Holiday Inn Express Fairfield 6755 Fairfield Business Dr., Fairfield, OH 45014 (513) 860-2900 www.hiexpress.com</p>	No	Yes	25	80	Yes	Indoor	Yes
MONROE	 <p>Best Western Monroe Inn 40 New Garver Rd., Monroe, OH 45050 www.bestwestern.com (513) 539-4400</p>	Yes	Yes	20	49	Yes	Outdoor	Yes
OXFORD	 <p>Baymont Inn & Suites Oxford 5190 College Corner Pike, Oxford, OH 45056 (513) 523-2722 www.baymontinns.com</p>	Yes	Yes	25	61	No	Indoor	Yes
	 <p>Best Western/Sycamore Inn 6 East Sycamore St., Oxford, OH 45056 (513) 523-0000 www.bestwestern.com</p>	No	Yes	25	61	No	Indoor	Yes
	 <p>Comfort Inn Oxford 5056 College Corner Pike, Oxford, OH 45056 (513) 524-0114 www.comfortinn.com</p>	Yes	Yes	25	66	No	Indoor	Yes
	 <p>Hampton Inn Oxford 375 S. College Ave., Oxford, OH 45056 (513) 524-2012 www.hamptoninn3.hilton.com</p>	Yes	Yes	15	74	No	Indoor	Yes
	 <p>The Elms Hotel 75 S Main St., Oxford, OH 45056 (513) 524-2002 www.theelmsoxford.com</p>	No	Yes	200	60	No	None	Yes

Select & Limited Service Hotels with Meeting Space (cont.)

WEST CHESTER & LIBERTY TOWNSHIPS



**AC Hotel by Marriott
Cincinnati at Liberty Center**

7505 Gibson St., Liberty Township, OH 45069
(513) 759-6500
achotels.marriott.com



Comfort Inn & Suites

5944 West Chester Rd., West Chester, OH 45069
(513) 645-1700
www.comfortinn.com



**Courtyard by Marriott
Cincinnati North**

6250 Muhlhauser Rd., West Chester, OH 45069
(513) 341-4140
www.marriott.com/cvgwcc



**Hampton Inn & Suites North
at Union Centre**

9266 Schulze Dr., West Chester, OH 45069
(513) 341-2040
www.cincinnatiunioncentresuites.hamptoninn.com



Quality Inn

8567 Cincinnati Dayton Rd., West Chester, OH 45069
(513) 755-3900
www.hiexpress.com



Homewood Suites West Chester

9226 Schulze Dr., West Chester, OH 45069
(513) 805-4400
www.homewoodsuites.com



Residence Inn Cincinnati North

6240 Muhlhauser Rd., West Chester, OH 45069
(513) 341-4040
www.marriott.com/cvgrw



Staybridge Suites Cincinnati North

8955 Lakota Dr. West, West Chester, OH 45069
(513) 645-9500
www.staybridge.com/cincinnati

All Non-Smoking	Continental Breakfast	Meeting Space Capacity	Number of Rooms	Pet Friendly	Pool	WiFi/ High-Speed Internet
Yes	No	124	130	No	Indoor	Yes
No	Yes	30	92	No	Indoor	Yes
Yes	No	50	126	No	Indoor	Yes
Yes	Yes	50	100	No	Indoor	Yes
No	Yes	20	61	No	Indoor	Yes
Yes	Yes	684	112	No	Indoor	Yes
Yes	Yes	50	100	Yes	Indoor	Yes
No	Yes	8	117	Yes	Indoor	Yes

Unique & Flexible Meeting Space

Butler County boasts an incredible variety of meeting space perfect for a variety of events from corporate retreats to day-long seminars to family gatherings. The following pages will help familiarize you with both large and small meeting facilities. Each venue offers a unique atmosphere and flavor all its own. For additional help planning your meeting or event, look no further than our talented events and meetings team. Contact us today at 513.860.4194.

Venue Space Under 10,000 Square Feet		Maximum Capacity	Number of Rooms	Banquet Capacity	Total Sq. Ft.	Theater Cap.	Reception Capacity	Classroom Capacity
	<p>Barn-n-Bunk Farm Market 3677 Wayne-Madison Rd., Trenton, OH 45067 (513) 988-9211 www.barnnbunk.com</p>	600	1	400	4,808	-	600	-
	<p>Brown's Run Country Club 6855 Sloebig Road, Middletown, OH 45042 (513) 423-9401 www.brownsruncc.com</p>	375	3	250	3,000	375	375	166
	<p>Butler County Metroparks Ronald Reagan Lodge 7850 VOA Park Dr., West Chester, OH 45069 (513) 755-4402 www.yourmetroparks.net</p>	480	4	250	4,650	450	375	160
	<p>Butler Technology & Career Development Schools 3603 Hamilton Middletown Rd, Hamilton, OH 45011 (513) 868-1334 www.butlertech.org</p>	450	5	316	3,800	-	450	200
	<p>Fitton Center for Creative Arts 101 S. Monument Ave., Hamilton, OH 45011 (513) 863-8873 www.fittoncenter.org</p>	510	5	250	7,263	375	375	-
	<p>Indiana Wesleyan Univ. Cincinnati Education & Conference Center 9286 Schulze Dr, West Chester, OH 45069 (513) 881-3600 www.indwes.edu/Cincinnati/Facilities/</p>	144	5	-	3,000	-	-	64
	<p>Lake Lyndsay Lodge 4845 Augspurgen Rd, Hamilton, OH 45011 (513) 868-8555 www.lakelyndsay.com</p>	670	3	400	9,600	-	600	-
	<p>Liberty Center 7100 Foundry Row, Liberty Township, OH 45069 (513) 644-0900 www.liberty-center.com</p>	250	2	200	-	250	200	168

Venue Space Under 10,000 Square Feet (cont.)		Maximum Capacity	Number of Rooms	Banquet Capacity	Total Sq. Ft.	Theater Cap.	Reception Capacity	Classroom Capacity
	<p>Miami University Voice of America Learning Center 847 VOA Park Dr., West Chester, OH 45069 (513) 895-8862 www.muohio.edu/voalc</p>	280	7	-	-	-	-	40
	<p>Michael J. Colligan Lodge 20 New London Rd., Hamilton, OH 45011 (513) 785-7060 www.hamilton-city.org</p>	96	1	84	1,010	-	95	56
	<p>Oxford Community Arts Center 10 South College Ave., Oxford, OH 45056 (513) 524-8506 www.oxarts.org</p>	300	4	200	5,251	150	300	-
	<p>Pyramid Hill Sculpture Park 1763 Hamilton-Cleves Rd. St. Rt. 128, Hamilton, OH 45013 (513) 868-8336 www.pyramidhill.org</p>	1000	4	300	6,000	1,000	500	75
	<p>Ryan's Tavern 241 High St., Hamilton, OH 45011 (513) 737-2200 www.ryanstavern.com</p>	260	3	150	2,235	160	225	100
	<p>The Elms Hotel 75 S Main St, Oxford, OH 45056 (513) 524-2002 www.theelmsoxford.com</p>	700	3	500	5,090	650	600	-
	<p>The Mulhauser Barn 8558 Beckett Rd., West Chester, OH 45069 (513) 759-7301 www.westchesteroh.org/parksandrec</p>	324	1	216	2,596	-	324	-
	<p>The Web Extreme Entertainment 7172 Cincinnati Dayton Rd., West Chester, OH 45069 (513) 860-2882 www.funattheweb.com</p>	350	8	280	2,632	200	350	72
	<p>Walden Ponds Golf Club 6090 Golf Club Ln., Fairfield Township, OH 45011 (513) 785-2999 www.waldenponds.com</p>	180	2	110	1,100	-	180	-
	<p>Wetherington Golf & Country Club 7337 Country Club Ln., West Chester, OH 45069 (513) 755-2582 www.wetheringtongcc.com</p>	375	1	250	3,000	-	375	-

Unique & Flexible Meeting Space

Venue Space Over 10,000 Square Feet

	Maximum Capacity	Number of Rooms	Total Sq. Ft.	Banquet Capacity	Theater Cap.	Reception Capacity	Classroom Capacity
<p>Armstrong Center at Miami University</p>  <p>This is the perfect place to host your next meeting, lecture, reception, banquet, wedding, or other special events. Our dynamic spaces, and professional event services team, will make your event one to remember.</p> <p>550 E Spring St., Oxford, OH 45056 (513) 529-2310 miamioh.edu/student-life/armstrong-student-center/</p>	850	4	14,000	500	800	750	330
<p>Butler County Fairgrounds</p>  <p>The Butler County Fairgrounds is home to the Butler County Fair and consists of 54 acres of exhibition buildings and grandstand seating. The fairgrounds and its facilities are available for rent throughout the year for exhibits, concerts, receptions, auctions and more.</p> <p>1715 Fairgrove Ave., Hamilton, OH 45011 (513) 892-1423 www.butlercountyohfair.org</p>	3,500	Banquet Exhibition Foyer	9,000 12,000 480	750 1,000 40	1,125 2,000 -	1,500 2,000 80	500 750 -
<p>Fairfield Banquet & Convention Center</p>  <p>This center features nine meeting rooms. Personalized professional service and the latest office equipment and technology are provided to fit your requirements. The beautiful grounds with gazebo are available for outdoor events.</p> <p>74 Donald Dr., Fairfield, OH 45014 (513) 829-8400 www.fairfieldconventionctr.com</p>	950	Conference Diamond Emerald Gazebo Opal Ruby Sapphire Topaz Victoria	284 2,700 2,700 1,800 1,350 500 3,000 300 6,500	12 225 225 - 125 50 250 30 550	- 337 337 300 186 62 375 37 812	- 337 337 - 168 62 375 37 812	- 150 150 - 75 27 166 16 360
<p>Oscar Event Center</p>  <p>The Oscar's warm decor is inviting and unique. Their staff is ready to meet all your needs. This center is attached to the Jungle Jims International Food Market, so add a cooking class or scavenger hunt in the food market to jazz up your meeting.</p> <p>5440 Dixie Highway, Fairfield, OH 45014 (513) 674-6000 www.junglejims.com</p>	1,250	Main Hall (North Hall) (South Hall) Meeting Room East Meeting Room West Pub Lounge	10,500	525 250 180 24 16 24 40	750 500 350 30 14 -	1,250 725 525 -	300 160 120 15 8 -

Unique & Flexible Meeting Space

Venue Space Over 10,000 Square Feet (cont.)

Maximum Capacity	Number of Rooms	Total Sq. Ft.	Banquet Capacity	Theater Cap.	Reception Capacity	Classroom Capacity
------------------	-----------------	---------------	------------------	--------------	--------------------	--------------------

Pendleton Art Center



This event center is sure to impress your attendees with inspiring art displayed all over the venue from local artists. It is a very creative and impressive venue to have exhibitions, events, and educational programs.

1105 Central Ave., Middletown, OH 45042
 (513) 559-3958
 www.pendletonartcenter.com

505	4	10,000	400	505	505	267
-----	---	--------	-----	-----	-----	-----

Receptions Conference Center



Host to all types of events from weddings to seminars to expos to luncheons and corporate events. The facility offers flexibility with various room sizes, beautiful décor, good visual site lines and a comfortable environment for fun or business.

5975 Boymel Dr., Fairfield, OH 45014
 (513) 860-4100
 www.receptionsinc.com

2,300	Buckeye	2,072	120	190	2,300	48
	Butler	3,827	265	330		140
	Fairfield	5,576	405	560		275
	Ohio	4,560	250	350		175
	State	620	48	60		32
	Carnation	624	48	60		28

Shriver Center at Miami University



The University Center opened its doors in 1957 to meet the social, cultural and recreational needs of the entire University community. The Shriver Center offers a wide variety of accommodations for conferences, banquets, lectures, weddings and other special events year-round.

701 E Spring St., Oxford, OH 45056
 (513) 529-4031
 www.carilloncatering.com

826	10	12,829	400	650	735	325
-----	----	--------	-----	-----	-----	-----

Savannah Center



From the elegant grand ballroom, to the perfectly equipped corporate rooms, to intimate breakfasts or sit-down dinners, Savannah Center consistently offers gracious service and the warmth of southern hospitality. Come experience the difference at the Savannah Center.

5533 Chappell Crossing, West Chester, OH 45069
 (513) 860-4142
 www.savannahcenter.com

1,700	18	44,000	930	1,630	1,700	720
-------	----	--------	-----	-------	-------	-----

A man and a woman are skydiving over a vast, hilly landscape under a clear blue sky. The man is in the foreground, wearing a white long-sleeved shirt, sunglasses, and a harness. He is smiling and giving a thumbs-up. The woman is behind him, wearing a blue jumpsuit and a harness, also smiling. The background shows a wide expanse of land with rolling hills and some buildings, viewed from a high altitude.

Where to HAVE FUN!

Butler County's got you covered! Get off the beaten path and try something new.

Butler County is bursting with an eclectic mix of places to have fun when work is done. Shop the region's best stores, wakeboard WITHOUT a boat or retreat into artistic splendor. Be sure to tempt your taste buds at one of our top-notch restaurants and experience fantastic nightlife at the new Liberty Center. There's always a great way to get away from the work and get out and play in Butler County.



Butler County is full of fun off-site options perfect for your meeting or event



Jungle Jim's International Market

Discover a foodie paradise like no other. Featured on Travel Channel, Good Morning America, and in BusinessWeek, Jungle Jim's is a theme park of food spanning more than 6 acres and featuring over 180,000 foods from around the globe.

www.junglejims.com



IKEA West Chester

Take a stroll through Ohio's only IKEA—a nearly endless array of room set ups, decorative finishing touches and more. You'll find everything you need to make your space your own. Don't miss the scrumptious Swedish meatballs in the café.

www.ikea.com



EnterTRAINment Junction & Escape The Room Challenge

EnterTRAINment Junction is home to the world's largest indoor train display chugging along 2 miles of track inside a 25,000 sq. ft. facility. And can you escape from a puzzle room in 60 minutes or less? Try out your teamwork at Escape The Room Challenge.

www.entertrainmentjunction.com and www.escapetheroomchallenge.com



Wake Nation

Go water skiing without a boat at the Midwest's only cable wake park. Visitors can wakeboard, water ski, kneeboard and wake skate while being towed around a 10-acre lake on a cable system.

www.wakenationcincinnati.com



BeauVerre Riordan Stained Glass Studios

In operation for more than 165 years, this historic gem is the oldest stained glass studio in the United States. Come see stunning stained glass creations in production. Some are even available for purchase.

www.beauverre.net



Pyramid Hill Sculpture Park

Find serenity among the natural surroundings of Pyramid Hill. Walk or drive-through a world of modern sculpture, or reflect on ancient cultures and art at the Ancient Sculpture Museum.

www.pyramidhill.org

Butler County is full of fun off-site options perfect for your meeting or event



Start Skydiving

Take the plunge at Start Skydiving, DropZone.com's #1 Best Rated Drop-Zone in the world. A staff of over 60+ professional personnel provides visitors the best training and finest skydiving experience.

www.startskydiving.com



Liberty Center

Welcome to the region's newest and largest shopping experience. With 1.2 million square feet of shopping, dining and entertainment options, your entire group will have fun here. Opened October 2015, it's not-to-be-missed!

www.liberty-center.com



Miami Valley Gaming

Try your luck at the region's only racino. Enjoy more than 1,600 gaming machines and choose from four delectable restaurants featuring casual to fine dining. Don't miss the harness racing.

www.miamivalleygaming.com



Topgolf

The ultimate venue for fun. No golf skills required. Just kick back and have a good time. An extensive menu, 200+ HDTVs and addictively fun games provide something for everyone! Opening Summer 2016.

www.topgolf.com



Main Event Entertainment

Eat. Bowl. Play. Find fun bowling, mini golf, karaoke, laser tag and so much more at Main Event Entertainment in West Chester. Opening Summer 2016.

www.mainevent.com

For more customized offsite options, please contact the BCVB at 513-860-4194.



Let's plan for **YOUR SUCCESS TOGETHER!**

BUTLER COUNTY IS READY TO TAKE YOUR UPCOMING MEETING TO THE NEXT LEVEL.

Your success is the ultimate plan. Our dedicated staff is here to listen to your needs and offer recommendations that best suits your group. The Butler County Visitors Bureau is at your service from the initial contact to the final good-bye, we are eager to help with every detail.

We welcome you to experience...

- First-class hotels and meeting space ready and willing to accommodate your group's needs.
- Superior customer service. We are extension of your team. Our success is your success.
- A perfect location in an up-and-coming destination that is easily accessible and within a day's drive of 60% of the US population.
- Amazing attractions and activities that you can't find anywhere else and will keep your group talking
- Incredible restaurants and nightlife that are sure to keep your guests entertained.



CONTACT US TODAY AND LET'S GET STARTED.

P: 888.462.2282 F: 513.860.4195 www.GetToTheBC.COM/Meeting



Follow us
ONLINE @

 facebook.com/GetToTheBC

 twitter.com/GetToTheBC

 pinterest.com/GetToTheBC

flickr flickr.com/GetToTheBC

 youtube.com/ButlerCountyVB

www.GetToTheBC.com/Meeting